

TBC1215

12mm brushless motor

最大功率	0.8W(外置驱动)	Power	0.8W(External Drive)
	/		/
电机寿命	约10000H(滚珠轴承)	Life Expectancy	~10000H(Ball Bearing)
	/		/

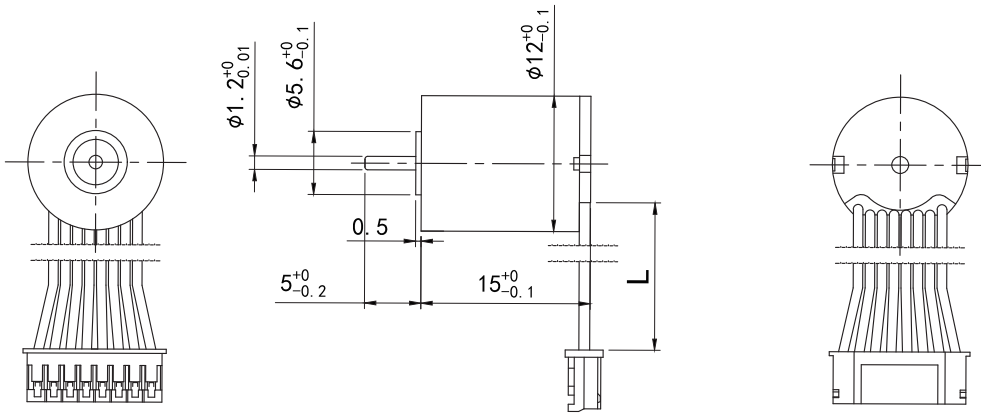

Weight:35g(Approx)

Unit(mm)

单电机技术参数 Motor Technical Data

电机型号 Motor model	额定电压 Rated voltage VDC	无负荷 No-load		额定 Rated				堵转 Stall	
		转速 Speed r/min	电流 Current mA	转速 Speed r/min	力矩 Torque g.cm	电流 Current mA	功率 Power W	力矩 Torque g.cm	电流 Current A
TBC1215HG	5	13500	40	12015	3	100	0.4	26	0.8
TBC1215HG	7.4	21000	60	18690	4	200	0.8	36	1.2

