

GMP22-TEC2418

22mm planetary gearbox plus 24mm brushless motor

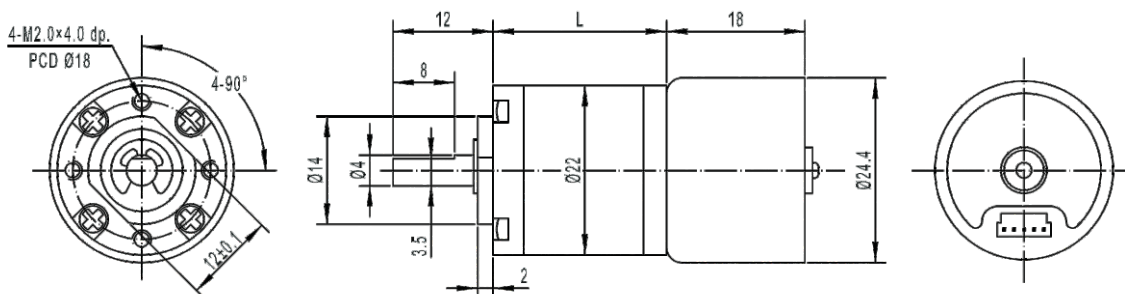

模数 Module	0.3				
额定负载 Rated torque (kg.cm)	3.0 kg.cm max				
瞬间允许力矩 Max momentary tolerance torque (kg.cm)	6.0 kg.cm max				
减速比 Reduction ratio	1/4 1/4.75	1/16 1/19 1/22.6	1/64 1/76 1/90 1/107	1/172、1/224 1/256、1/304 1/361、1/428.7 1/509	1/1024
齿轮箱减速级数 Number of gear stages	1	2	3	4	5
减速箱长度 L (mm)	12.5	16	19.5	23	26.5



Weight: 90g(Approx)

Unit(mm)

减速电机技术参数 Gear Motor Technical Data

减速比 Reduction ratio		16	64	84	107	224	304	361	428.7	1014
12.0V	空载转速 No-load speed (rpm)	380	96	70	58	27	20	17	14	6
	负载转速 Rated speed (rpm)	320	80	60	47	22	16	14	13	5
	负载力矩 Rated torque (kg.cm)	0.2	0.7	1.0	1.2	1.8	2.6	3.0	3.0	3.0
24.0V	空载转速 No-load speed (rpm)	540	135	100	80	38	28	24	20	8
	负载转速 Rated speed (rpm)	470	115	90	70	33	24	20	17	7
	负载力矩 Rated torque (kg.cm)	0.2	0.7	1.0	1.2	1.8	2.6	3.0	3.0	3.0

单电机技术参数 Motor Technical Data

电机型号 Motor model	额定电压 Rated voltage	无 荷 No-load		额 定 Rated				堵 转 Stall	
		转 速 Speed	电 流 Current	转 速 Speed	力 矩 Torque	电 流 Current	功 率 Power	力 矩 Torque	电 流 Current
		VDC	r/min	mA	r/min	g.cm	mA	W	g.cm
TEC2418-1262	12.0	6200	60	5100	20	180	1.05	110	0.7
TEC2418-2487	24.0	8700	50	7500	20	130	1.54	145	0.7

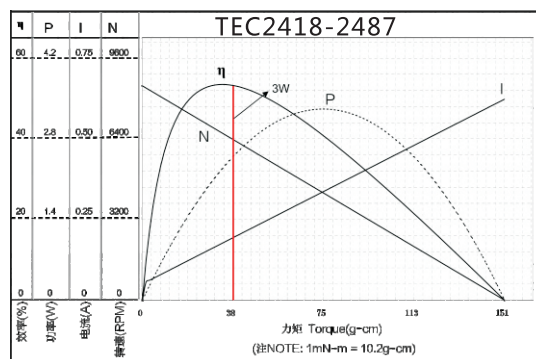
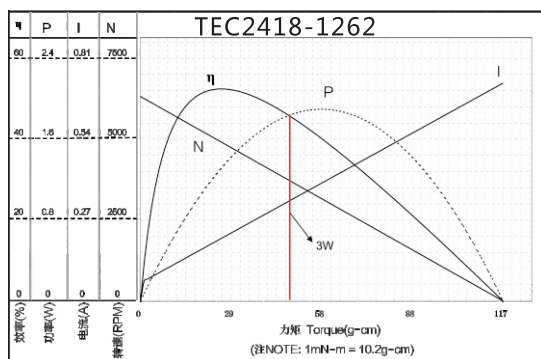

备注：红线左侧为电机可以连续工作区域 NOTE: the left side of red line area can continuous work