

# GMP22-180SH

22mm planetary gearbox plus 180 permanent magnet DC motor

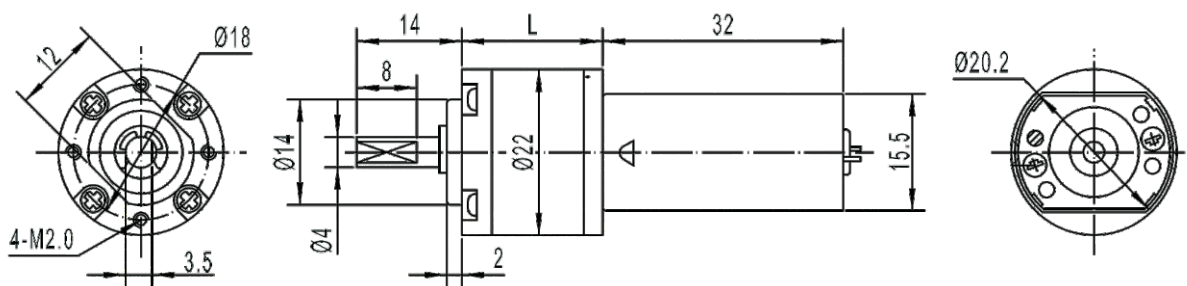

模数 Module	0.3				
额定负载 Rated torque (kg.cm)	3.0 kg.cm max				
瞬间允许力矩 Max momentary tolerance torque (kg.cm)	6.0 kg.cm max				
减速比 Reduction ratio	1/4 1/4.75	1/16 1/19 1/22.6	1/64 1/76 1/90 1/107	1/172、1/224 1/256、1/304 1/361、1/428.7 1/509	1/1024
齿轮箱减速级数 Number of gear stages	1	2	3	4	5
减速箱长度 L (mm)	12.5	16	19.5	23	26.5



Weight: 90g(Approx)

Unit(mm)

## 减速电机技术参数 Gear Motor Technical Data

减速比 Reduction ratio		16	64	84	107	224	304	361	428.7	1024
6.0V	空载转速 No-load speed (rpm)	430	105	80	65	30	22	18	16	6
	负载转速 Rated speed (rpm)	370	90	70	55	26	19	16	14	5
	负载力矩 Rated torque (kg.cm)	0.2	0.7	1.0	1.2	2.0	2.8	3.0	3.0	3.0
12.0V	空载转速 No-load speed (rpm)	300	75	60	45	21	15	13	11	5
	负载转速 Rated speed (rpm)	270	65	50	40	19	14	12	10	4
	负载力矩 Rated torque (kg.cm)	0.12	0.35	0.5	0.6	1.0	1.4	1.7	2.0	3.0

## 单电机技术参数 Motor Technical Data

电机型号 Motor model	额定电压 Rated voltage	无负荷 No-load		额定 Rated				堵转 Stall	
		转速 Speed	电流 Current	转速 Speed	力矩 Torque	电流 Current	功率 Power	力矩 Torque	电流 Current
	VDC	r/min	mA	r/min	g.cm	mA	W	g.cm	A
TFF-180SH-18140	6.0	7000	90	5900	20	350	1.21	127	1.80
TFF-180SH-10400	12.0	5000	20	4300	10	70	0.44	71	0.42

