

# GMP20-180SH

20mm planetary gearbox plus 180 permanent magnet DC motor

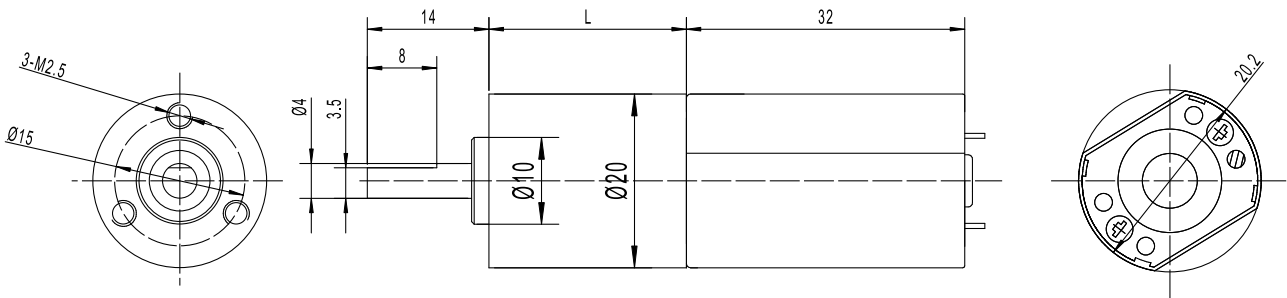

模数 Module	0.35			
额定负载 Rated torque (kg.cm)	3.5kg.cm max			
瞬间允许力矩 Max momentary tolerance torque (kg.cm)	6.0kg.cm max			
减速比 Reduction ratio	1/4.385 1/5.42	1/19 1/23.6 1/29	1/84、1/104 1/128、1/157	1/370、1/455 1/560、1/690 1/850
齿轮箱减速级数 Number of gear stages	1	2	3	4
减速箱长度 L (mm)	14.5	18.5	23	27



Weight: 70g(Approx)

Unit(mm)

## 减速电机技术参数 Gear Motor Technical Data

电压 Voltage	减速比 Reduction ratio	额定负载 Rated torque (kg.cm)								
		5.4	19	29	104	128	157	370	560	850
6V	空载转速 No-load speed (rpm)	1290	365	240	65	52	42	18	12	8
	负载转速 Rated speed (rpm)	1090	305	200	55	45	35	16	10	7
	负载力矩 Rated torque (kg.cm)	0.08	0.24	0.37	1.1	1.3	1.6	3	3.5	3.5
	空载转速 No-load speed (rpm)	920	260	170	46	38	31	13	9	6
12V	负载转速 Rated speed (rpm)	790	220	145	40	33	27	11	7	5
	负载力矩 Rated torque (kg.cm)	0.04	0.12	0.19	0.53	0.66	0.8	1.5	2.3	3.5
	空载转速 No-load speed (rpm)	920	260	170	46	38	31	13	9	6

## 单电机技术参数 Motor Technical Data

电机型号 Motor model	额定电压 Rated voltage	无负荷 No-load		额定 Rated				堵转 Stall	
		转速 Speed	电流 Current	转速 Speed	力矩 Torque	电流 Current	功率 Power	力矩 Torque	电流 Current
	VDC	r/min	mA	r/min	g.cm	mA	W	g.cm	A
TFF-180SH-18140	6	7000	90	5900	20	350	1.21	127	1.80
TFF-180SH-10400	12	5000	20	4300	10	70	0.44	71	0.42

