

GMP12T-TBC1215

12mm gearbox plus 1215 permanent magnet DC motor

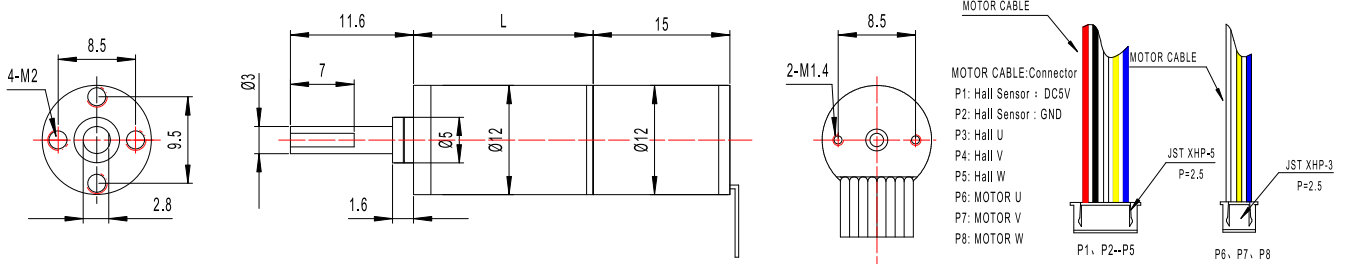

| | | | | |
|--|------------|----------------------|--------------------------|--------------------------------------|
| 模数 Module | 0.2 | | | |
| 额定负载 Rated torque (kg.cm) | 2kg.cm max | | | |
| 瞬间允许力矩 Max momentary tolerance torque (kg.cm) | 4kg.cm max | | | |
| 减速比 Reduction ratio | 1/4 1/6 | 1/16 1/24 1/36 | 1/64、1/96 1/144、1/216 | 1/256、1/384 1/576、1/864 1/1296 |
| 齿轮箱减速级数 Number of gear stages | 1 | 2 | 3 | 4 |
| 减速箱长度 L (mm) | 14.9 | 19.7 | 24.5 | 29.3 |



Weight: 35g(Approx)

Unit(mm)

减速电机技术参数 Gear Motor Technical Data

| 电压 Voltage | 减速比 Reduction ratio | Gear Ratio | | | | | | | |
|------------|---------------------------|------------|------|------|------|------|-----|-----|------|
| | | 4 | 16 | 36 | 64 | 96 | 216 | 576 | 1296 |
| 8V | 空载转速 No-load speed (rpm) | 6250 | 1562 | 694 | 390 | 260 | 116 | 43 | 19 |
| | 负载转速 Rated speed (rpm) | 4000 | 1000 | 444 | 250 | 166 | 74 | 28 | 12 |
| | 负载力矩 Rated torque (kg.cm) | 0.03 | 0.09 | 0.2 | 0.3 | 0.44 | 1.0 | 2.0 | 2.0 |
| 12V | 空载转速 No-load speed (rpm) | 7500 | 1875 | 833 | 469 | 312 | 139 | 52 | 23 |
| | 负载转速 Rated speed (rpm) | 4750 | 1188 | 528 | 297 | 198 | 88 | 33 | 15 |
| | 负载力矩 Rated torque (kg.cm) | 0.04 | 0.11 | 0.25 | 0.36 | 0.54 | 1.2 | 2.0 | 2.0 |

单电机技术参数 Motor Technical Data

| 电机型号 Motor model | 额定电压 Rated voltage | 无负荷 No-load | | 额定 Rated | | | 堵转 Stall | | |
|---------------------|-----------------------|-------------|---------------|-------------|--------------|---------------|-------------|--------------|---------------|
| | | 转速 Speed | 电流 Current | 转速 Speed | 力矩 Torque | 电流 Current | 功率 Power | 力矩 Torque | 电流 Current |
| | VDC | r/min | mA | r/min | g.cm | mA | W | g.cm | A |
| TBC1215-08250 | 8 | 25000 | 100 | 16000 | 9 | 420 | 1.50 | 25 | 1 |
| TBC1215-12300 | 12 | 30000 | 120 | 19000 | 11 | 420 | 2.10 | 30 | 0.95 |

