

# GM24-N20VA 24 × 12mm gearbox plus N20 permanent magnet DC motor

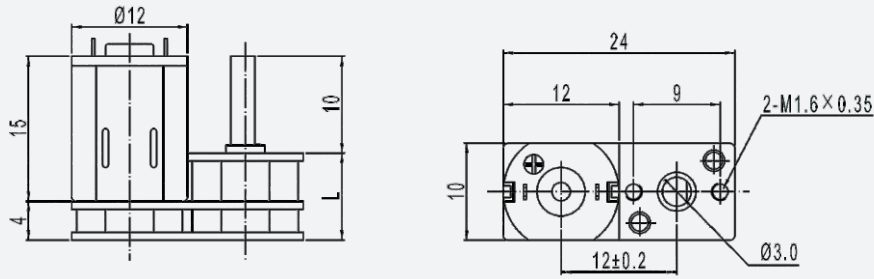

模数 Module	0.15	0.25
额定负载 Rated torque (kg.cm)	0.5 kg.cm max	1.0 kg.cm max
瞬间允许力矩 Max momentary tolerance torque (kg.cm)	1.0 kg.cm max	2.0 kg.cm max
减速比 Reduction ratio	1/150、1/350、1/500	1/47、1/120 1/165、1/250
齿轮箱减速级数 Number of gear stages	6	
减速箱长度 Gearbox length L (mm)	9.0	



Weight: 12g(Approx)

Unit(mm)

## 减速电机技术参数 Gear Motor Technical Data

电压 Voltage	减速比 Reduction ratio	性能 Performance								
		空载转速 No-load speed (rpm)	负载转速 Rated speed (rpm)	负载力矩 Rated torque (kg.cm)	空载转速 No-load speed (rpm)	负载转速 Rated speed (rpm)	负载力矩 Rated torque (kg.cm)	空载转速 No-load speed (rpm)	负载转速 Rated speed (rpm)	负载力矩 Rated torque (kg.cm)
2.4V	47	300	255	0.06	96	80	0.2	30	25	0.5
	120	120	100	0.16	88	73	0.22	42	34	0.4
	150	96	80	0.2	58	48	0.34	30	25	0.5
	165	88	73	0.22	42	34	0.4	25	20	0.3
5.0V	250	58	48	0.34	30	25	0.5	20	16	0.2
	350	42	34	0.4	25	20	0.3	16	12	0.15
	500	30	25	0.5	16	12	0.15	12	9	0.1
		25	20	0.3	12	9	0.1	9	7	0.07

## 单电机技术参数 Motor Technical Data

电机型号 Motor model	额定电压 Rated voltage	无负荷 No-load		额定 Rated			堵转 Stall		
		转速 Speed	电流 Current	转速 Speed	力矩 Torque	电流 Current	力矩 Torque	电流 Current	
	VDC	r/min	mA	r/min	g.cm	mA	W	g.cm	A
TFF-N20VA-13110	2.4	14800	60	12100	2.5	260	0.31	14	1.20
TFF-N20VA-09220	5.0	14800	30	12000	2.5	120	0.31	13	0.52

